

# Open House Day 2016

22 October, 11:00–18:00



Dear Visitor,

We would like to thank you for choosing to visit ESO, the European Southern Observatory, and to offer you a warm welcome to our Headquarters. Below you will find a programme of activities, as well as a map to guide you around the building.

If you need help on your way, look for our members of staff, who are wearing badges. As ESO is an international organisation, we have staff speaking various languages.

## Programme

1

**Welcome to ESO.** Get free material about ESO, an event programme, a map of the building, and help with directions. Children can pick up passports to collect stamps and get a chance to win gifts if they accumulate all of the stamps from our activities (on departure, gifts can be collected from area 17). Children can also pick up an album for stickers here.

2

**ESO and ALMA exhibitions with models, Ask an astronomer.** Embark on all-inclusive journeys into and around some of ESO's most breathtaking sites and groundbreaking instruments. Learn more about ESO's telescopes and science. If you have questions, look for one of our staff members wearing an "Ask an astronomer" badge and they will be happy to help. **Stamp station and stickers.**

3

**Adaptive Optics Demonstration.** Our experts will introduce you to a system used on telescopes called adaptive optics (AO) and explain how AO is useful for direct imaging of exoplanets.

4

**ESO Chile Chill.** Take a moment to relax by watching incredible images from our sites in Chile and listen to a chill out session.

5

**Picture book presentation.** Join Space Rock Pedro and his friends on their exciting adventures. For children. Shows start at 11:15, 12:15, 13:15, 14:15, 15:15, 16:15 and 17:15 (duration 30 minutes).

6

**Stellarium and a photo collection of the night sky.** A demonstration of the Stellarium software and other resources, and how you can use them to find your way around the night sky. You can also admire vistas of the night sky.

7

**Exploring the night sky.** Discover the amazing astronomical objects you can see throughout the year and how to identify the bright stars and major constellations the next time you're out stargazing. Presentations in German at 11:30, 13:30, 15:30 and 17:30; presentations in English at 12:30, 14:30 and 16:30. **Stamp station and stickers.**

8

**Guided tours of ESO.** Join our guides on a tour through the ESO premises and learn more about ESO and the new Headquarters extension building. Tours start every 30 minutes between 11:30 and 17:00. Registration at the starting point of the tour is required. Tours in German. English tours on demand.

9

**Guided tours of the European Extremely Large Telescope (E-ELT) prototype components and astronomical instrumentation.** ESO builds some of the largest telescopes in the world. Visit our new integration laboratory and learn about instruments, E-ELT prototype component testing and optical experiments done to optimise the performance of telescopes. Tours start every 30 minutes between 11:15 and 17:15.

10

**ESOshop.** If you are looking for souvenirs or gifts, this is the place to be. Our products include books, clothing, postcards and stickers.



# Programme

11

## Live connection to Paranal and ALMA in Chile, talks and documentaries.

- 11:25 – 11:40** Documentary: Europe to the Stars – ESO’s first 50 years of Exploring the Southern Sky (English, short version)
- 11:45 – 12:15** Talk: Paranal – unser Auge ins Universum (in German)
- 12:20 – 12:50** Talk: Unsere Planeten (for children of primary school age, in German)
- 12:55 – 13:25** Talk: Die Suche nach der zweiten Erde (in German)
- 13:30 – 14:00** Talk: ALMA – ein neues Auge blickt tief ins Weltall (in German)
- 14:05 – 14:30** Live connection to ALMA, Chile
- 14:35 – 14:45** ESOcast: Planet found around closest star (German subtitles)
- 14:50 – 15:20** Talk: ESO – eine allgemeine Einführung (suitable for children over 8 years, in German)
- 15:25 – 15:55** Talk: Die Suche nach außerirdischem Leben – und was wir von der Erde lernen können (in German)
- 16:00 – 16:25** Live connection to Paranal, Chile
- 16:30 – 17:00** Talk: Warum gibt es noch Leben auf der Erde? (in German)
- 17:05 – 17:35** Talk: The origins of planets, stars and galaxies as seen by ALMA (in English)
- 17:40 – 17:55** Documentary: ALMA – In Search of our Cosmic Origins (English with German subtitles)

12

**Cafeteria.** Free drinks are available for our visitors. For a small donation to our Charity Group, you can also enjoy an international buffet with traditional food from around the world, all home-made by our staff.

13

**Observing with a telescope.** If we have clear skies, AGAPE astronomers will show you the Sun using a special filter on their telescopes.

14

**Infrared photography.** Have your infrared picture taken!

15

**Youngsters Corner.** Looking for future Co-Workers! See how creative, exciting and varied technology is! Give it a try: Come with us on a hands-on tour, with workshops and experiments – or simply ask us questions to your heart’s content!  
**Stamp station and stickers.**

16

**Comet factory.** At this spectacular comet making demonstration learn about comets and what they’re made of. Hourly shows, presentations in German at 12:00, 14:00 and 16:00; English presentations at 13:00, 15:00 and 17:00. **Stamp station and stickers.**

17

**Face painting and Lego telescope building.** Children will have lots of fun having their faces painted with diverse astronomical themes, such as stars, galaxies or comets. You can also build your very own mini-telescope out of Lego (limited number available)! If you have visited all our stamp stations, you can pick up your gift here. **Stamp station and stickers.**

If you plan to take photos during the event, we invite you to share them with us on our Flickr group:  
<http://www.flickr.com/groups/yourespictures/>

We would also like to invite you to share your impressions about the ESO Open House Day over Twitter @ESO or on our Facebook page:  
<https://www.facebook.com/ESO Astronomy>

Thank you for joining us today!



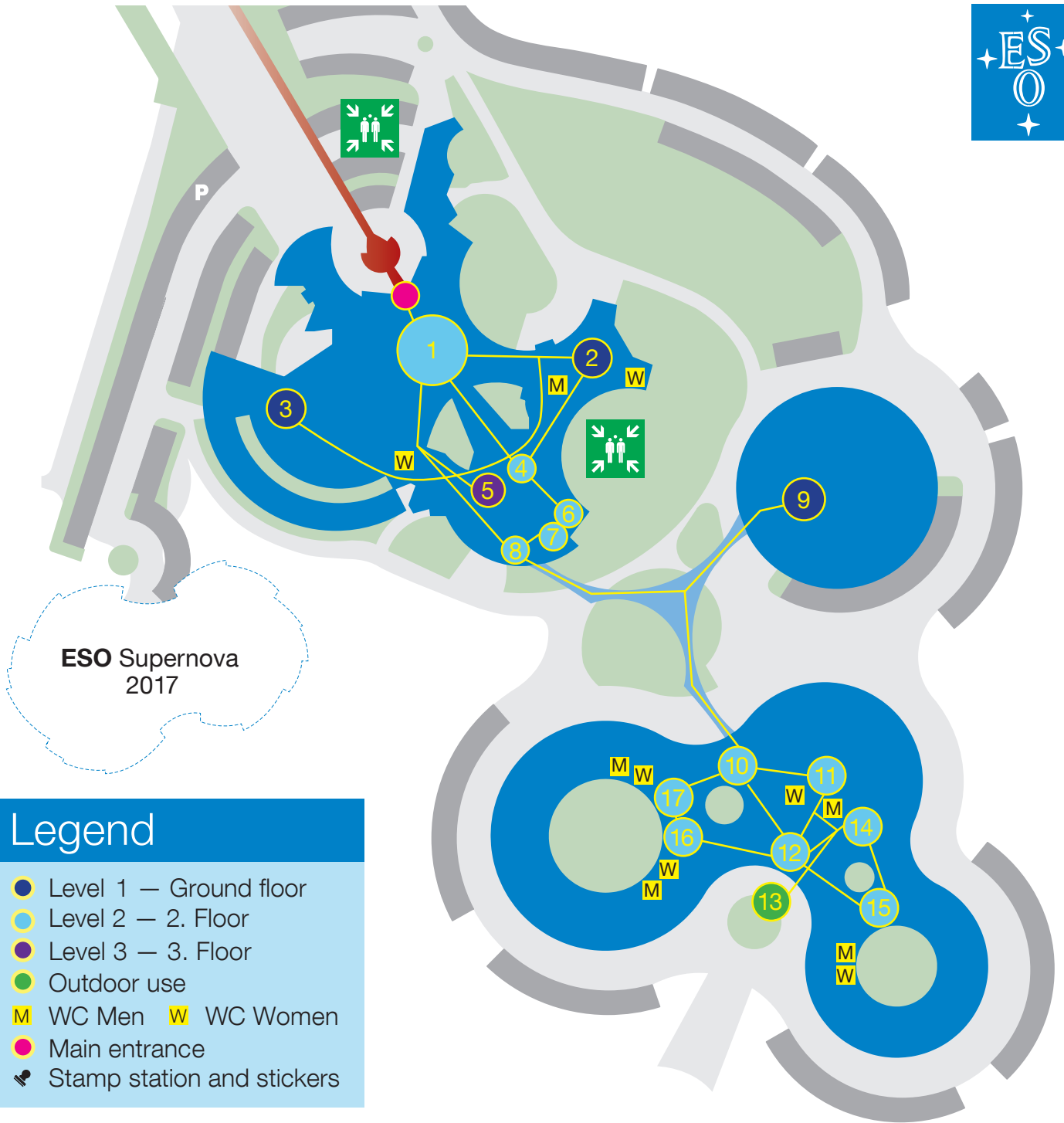

ESO Supernova  
2017

## Legend

- Level 1 — Ground floor
- Level 2 — 2. Floor
- Level 3 — 3. Floor
- Outdoor use
- M WC Men   W WC Women
- Main entrance
- Stamp station and stickers

## Directory

- |   |  |
|---|--|
| <p><b>1</b> Welcome to ESO</p> <p><b>2</b> ESO and ALMA exhibitions with models, Ask an astronomer </p> <p><b>3</b> Adaptive Optics Demonstration</p> <p><b>4</b> ESO Chile Chill</p> <p><b>5</b> Picture book presentation</p> <p><b>6</b> Stellarium and a photo collection of the night sky</p> <p><b>7</b> Exploring the night sky </p> <p><b>8</b> Guided tours of ESO</p> | <p><b>9</b> Guided tours of the E-ELT prototype components and astronomical instrumentation</p> <p><b>10</b> ESOshop</p> <p><b>11</b> Live connection to Paranal and ALMA in Chile, talks and documentaries</p> <p><b>12</b> Cafeteria</p> <p><b>13</b> Observing with a telescope</p> <p><b>14</b> Infrared photography</p> <p><b>15</b> Youngsters Corner </p> <p><b>16</b> Comet factory </p> <p><b>17</b> Face painting and Lego telescope building </p> |
|---|--|